



## 12 Detailed Battery Parts list

### 12.1 Battery Exploded View

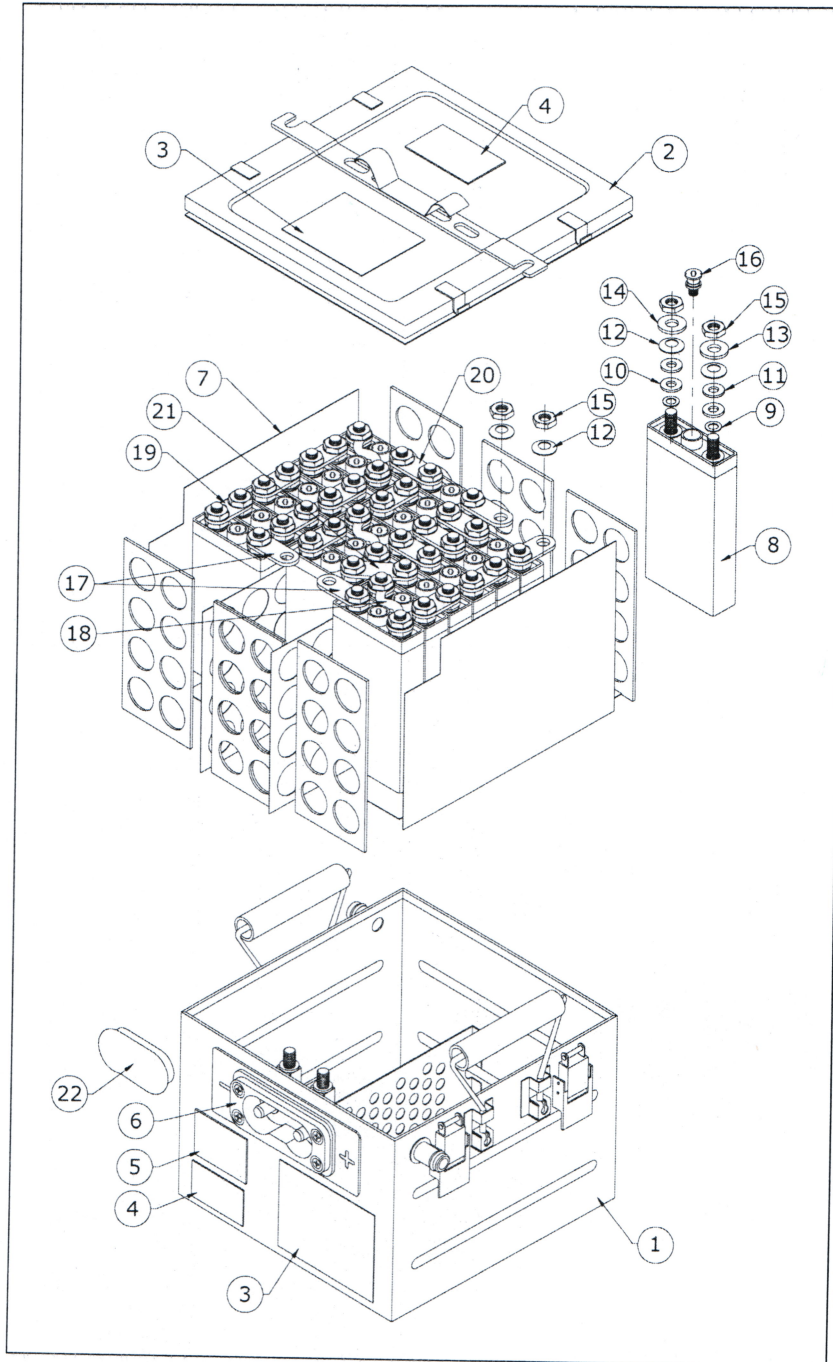

Figure 12: Battery Exploded View



## 12.2 Battery Parts List

#	Description	Part Number	Quantity per Battery
1	Battery Container Assembly	233 2101	01
2	Battery Lid Assembly	233 2201	01
3	Battery Label	233 2003	02
4	Caution Label	233 2002	02
5	Recycling Label	521 1009	01
6	Connector Assembly	233 3000	01
7	Spacers Kit	---	1 Set
8	Wet Cell Assembly (NCSP C 23060 LM)	233 5001	20
9	'O' Ring for Stem	341 5015	40
10	Teflon Washer	521 6802	40
11	Terminal Plain Washer	261 6801	40
12	Terminal Belleville Washer	521 6805	82
13	Terminal Indication Bush (Red)	531 4104	20
14	Terminal Indication Bush (Blue)	531 4103	20
15	Terminal Nut	261 6804	82
16	Vent Assembly	233 5121	20
17	I.C.C. - 23301	233 2005	02
18	I.C.C. - 23302	233 2013	03
19	I.C.C. - I	401 2006	10
20	I.C.C. - XXXIII	404 2003	05
21	I.C.C. - 23303	233 2004	01
22	Connector Cover	271 1002	01

**NOTE:** The serial numbers of the parts listed in this table correspond with the serial numbers of the parts shown in the Battery Exploded View under Section 12.1.

## 12.3 Battery Spare Parts List

The following spare parts given along with each battery.

#	Item	Part Number	Quantity
1	Inter-cell connector (ICC) - I	401 2006	1
2	Inter-cell connector (ICC) - XXXIII	404 2003	1
3	Vent Screw assembly	233 5121	2
4	Vent 'O' ring	261 6556	2
5	Vent sleeve	261 6555	2
6	Terminal nut	261 6804	2
7	Terminal indication bush (Blue)	531 4103	2
8	Terminal indication bush (Red)	531 4104	2
9	Terminal Belleville washer	521 6805	2